

Enhanced Push-to-Talk (EPTT) Quick Start Guide









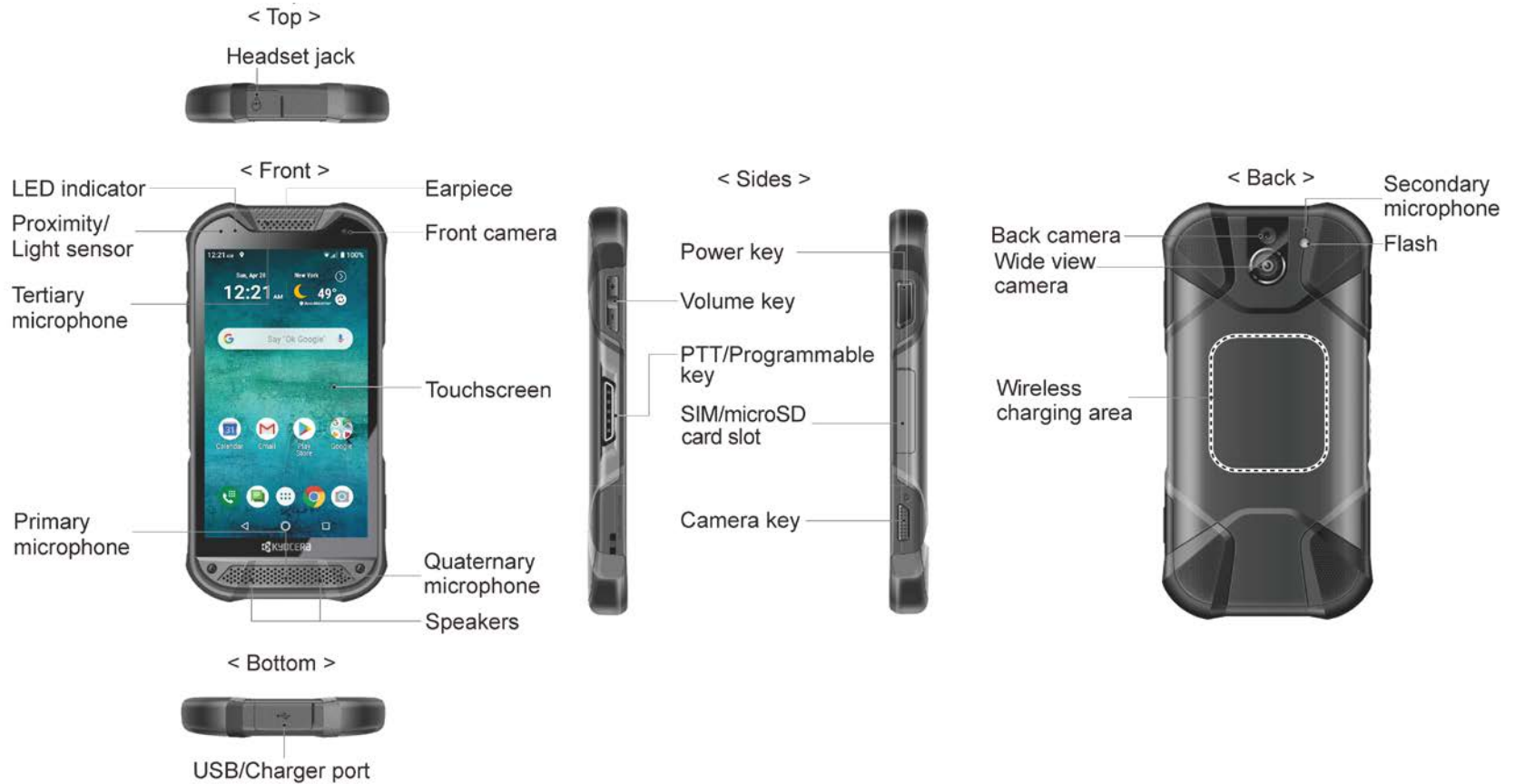



**DURA FORCE
PRO 2**

by  **KYOCERA**

Phone at a Glance



Notification Icons

Icon	Status
	PTT available
	PTT offline
	PTT do not disturb
	Missed call
	New mail
	New message
	Event
	Music application is running in the background
	Alarm
	Downloading

Initial Activation of EPTT

Install the EPTT Application

1. From the home screen, tap  > **AT&T EPTT**.

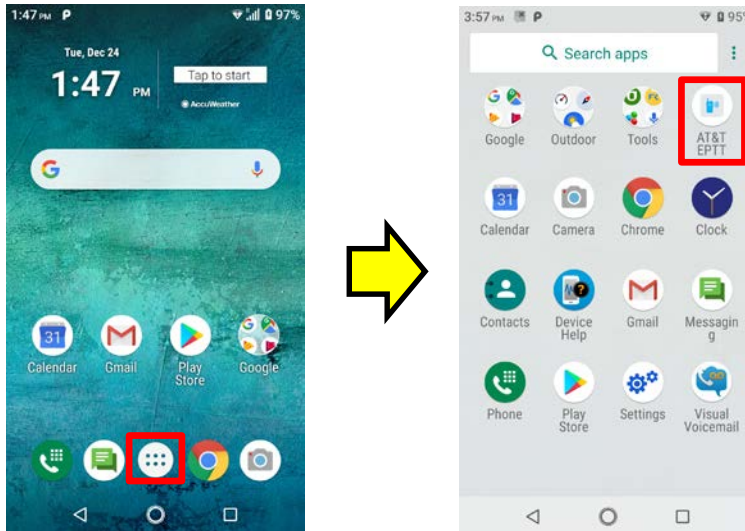

Note: Upon first access, the application download screen on Google Play Store is displayed. Follow the on-screen prompts to complete the update.

Initial Activation of EPTT

Activate the EPTT

1. Review the End User License Agreement, then tap the Checkmark icon.
2. Review the Confirm activation prompt, then tap Yes.

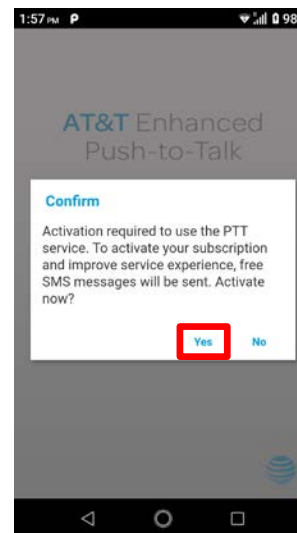
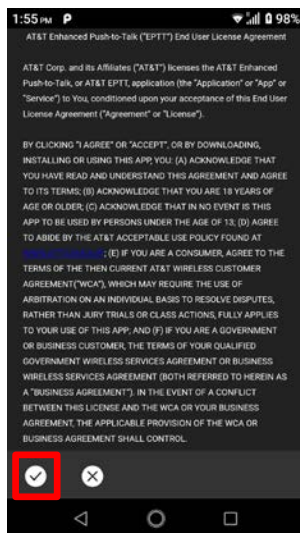

Initial Activation of EPTT

3. Tap **View Tutorial** to view a tutorial on AT&T Enhanced Push-to-Talk.
- or -
Tap **Skip Tutorial** to continue to the application without viewing the tutorial.

*Note: The tutorial can be viewed later in the AT&T Enhanced Push-to-Talk Settings. From the AT&T EPTT application, tap  > **Tutorial**.*

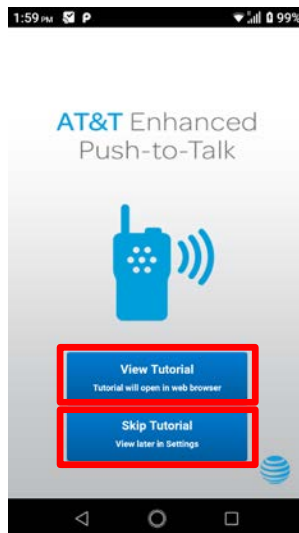

Assign a EPTT to PTT key

Assign a EPTT to PTT key

1. From the home screen, tap  > **Settings** > **Programmable keys** > **PTT key**.
2. Tap **AT&T EPTT**.

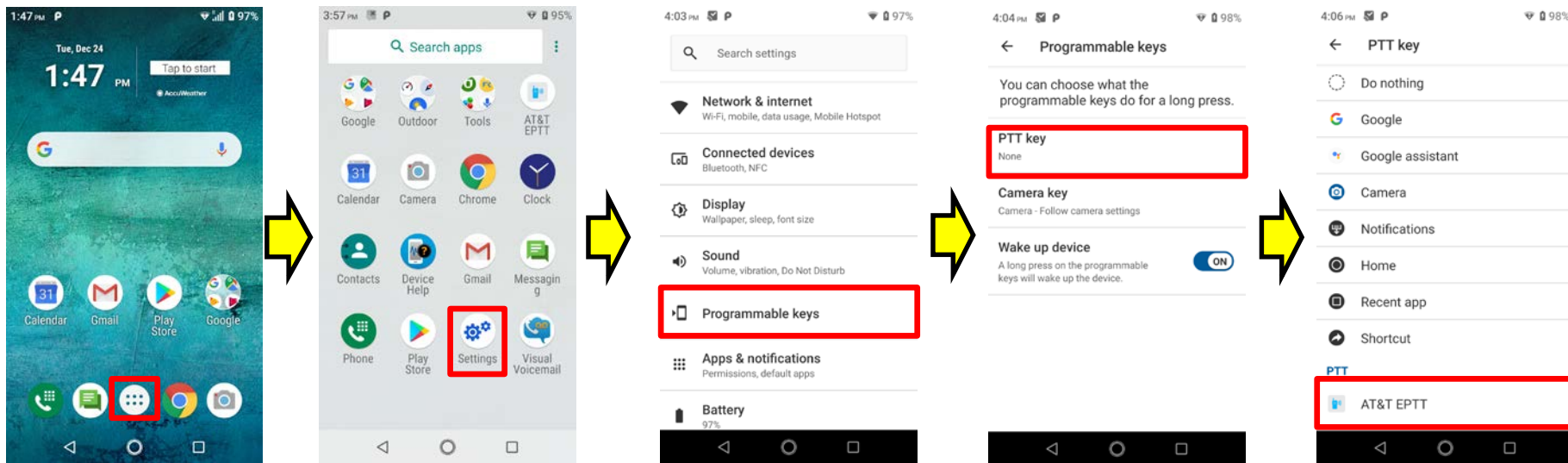

Assign a EPTT to PTT key

1. From the home screen, press the **PTT key** and tap **ASSIN**.
2. Tap **AT&T EPTT**.

*Note: If you do this before installing and activating the application, you will see **Install AT&T EPTT** instead of **AT&T EPTT**. Tap **Install AT&T EPTT** to install the EPTT application.*

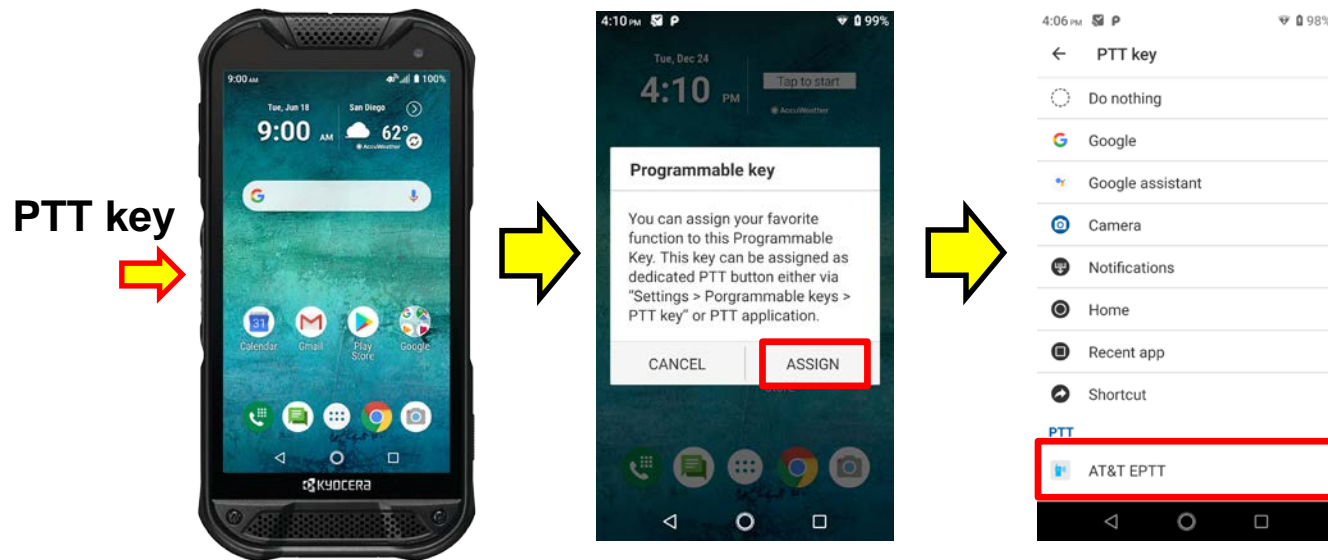

Assign a EPTT to Camera key

Assign a EPTT to Camera key

1. From the home screen, tap  > **Settings** > **Programmable keys** > **Camera key**.
2. Tap the **AT&T EPTT**.

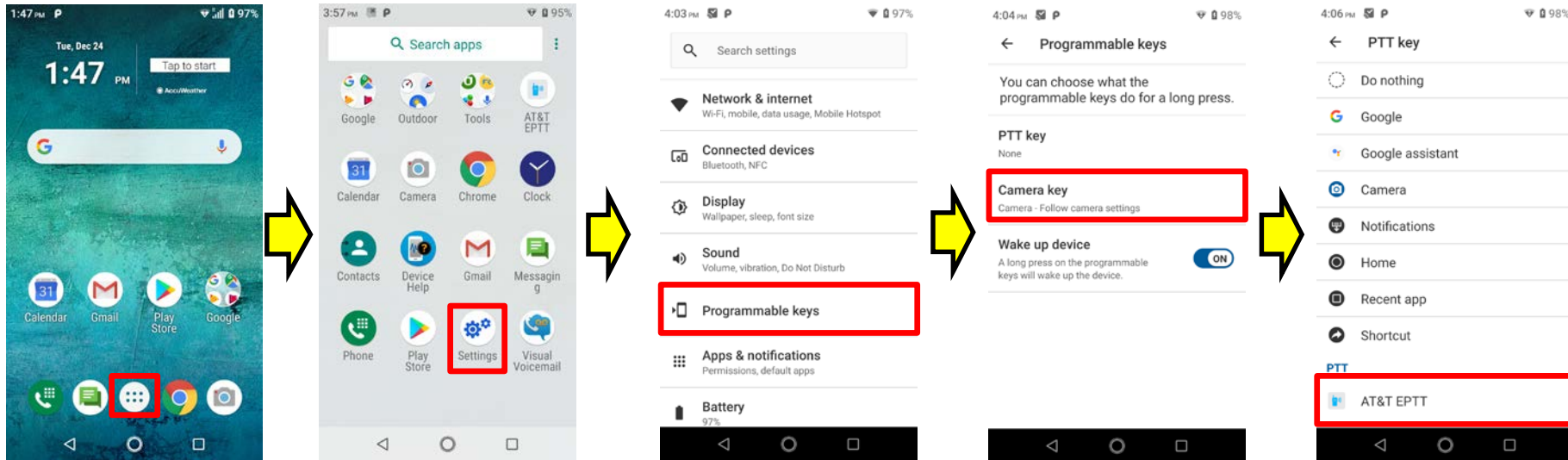



History: Displays all your conversation history of calls, contacts, groups, alerts, messages (text, image, video, and voice).



Favorites: Displays your favorite EPTT contacts and talk groups.

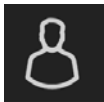

Contacts: Displays EPTT contacts and allows to create/edit/delete a contact or initiate an EPTT call



Group: Displays EPTT talk groups and allows to created/edit/delete a group or initiate a group call.





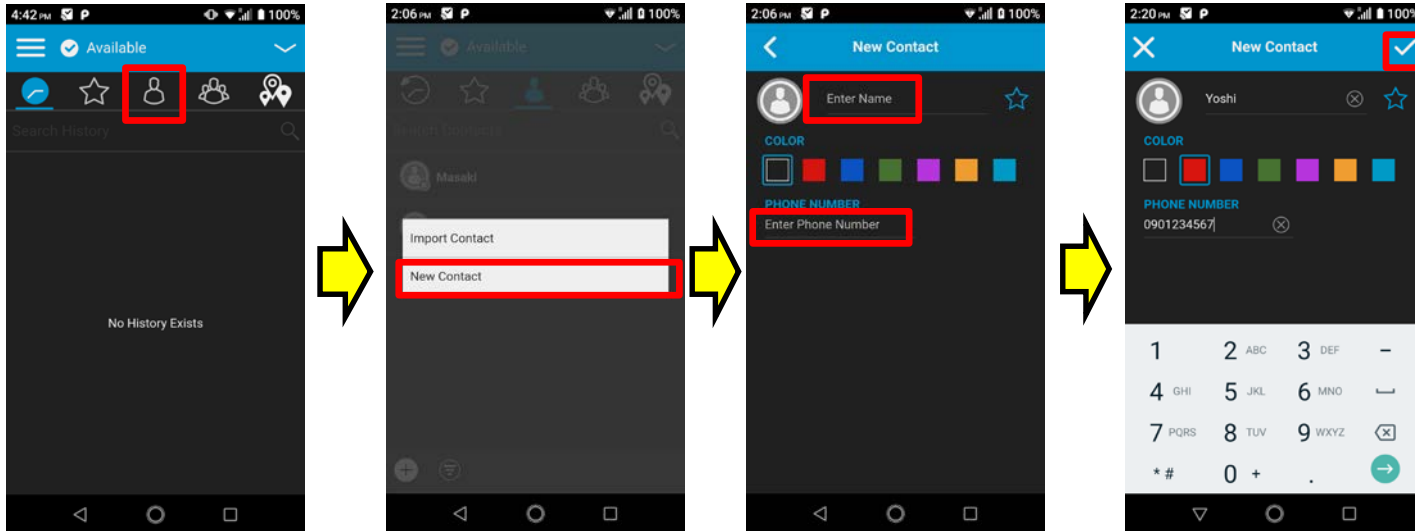

Location: Displays your location and allows you to send your location to others.

Add a Contact

1. Tap > **AT&T EPTT**.
2. Tap > .
3. Tap **New Contact**.
4. Enter the contact's name and phone number.
5. Tap .



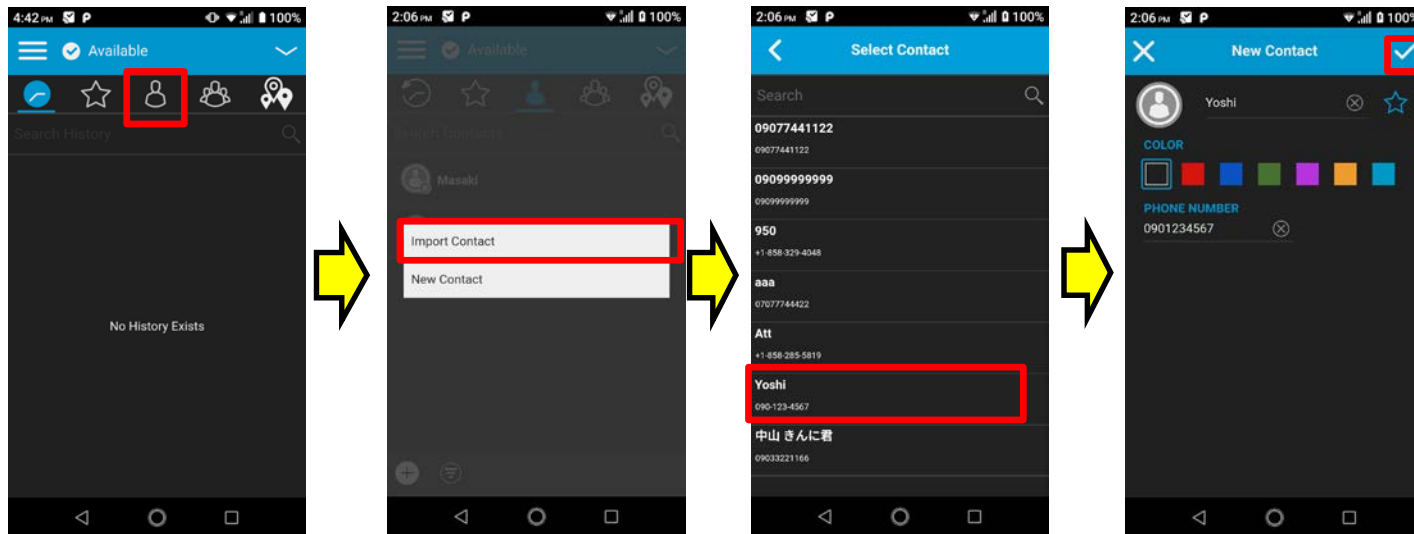

Add a Contact

1. Tap  > **AT&T EPTT**.
2. Tap  >  .
3. Tap **Import Contact**
4. Select the contact you want add.
5. Tap  .



Delete a Contact

1. Tap  > **AT&T EPTT**.
2. Tap .
3. Tap and hold the contact you want to delete.
4. Tap **Details**.
5. Tap  > **Yes**.

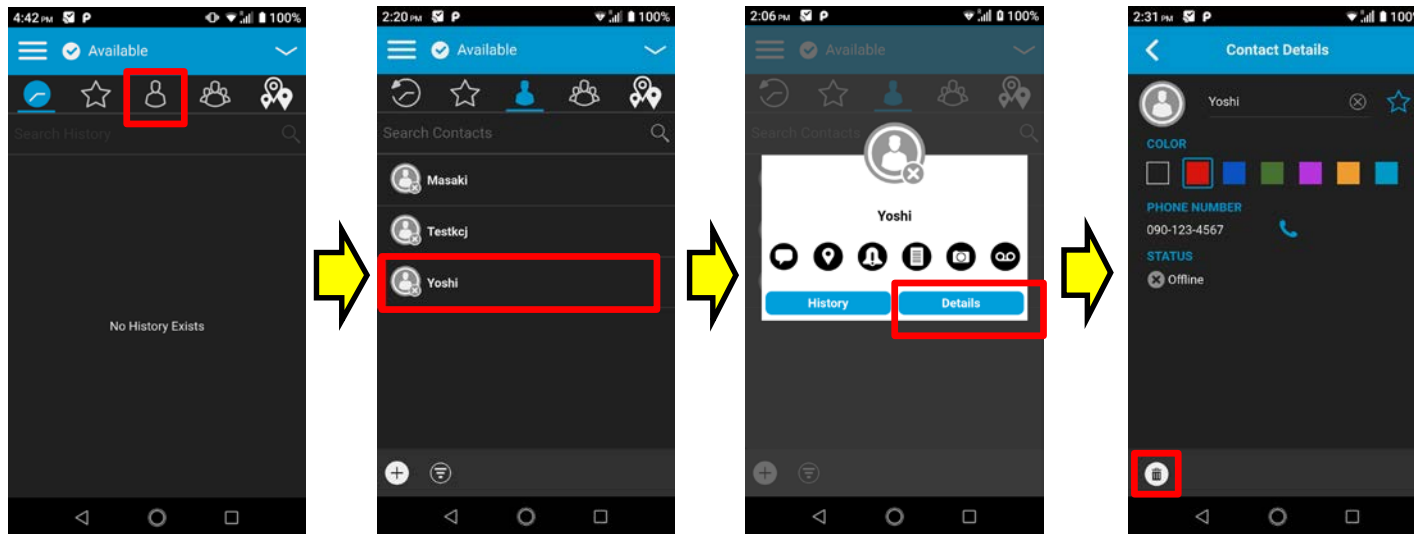



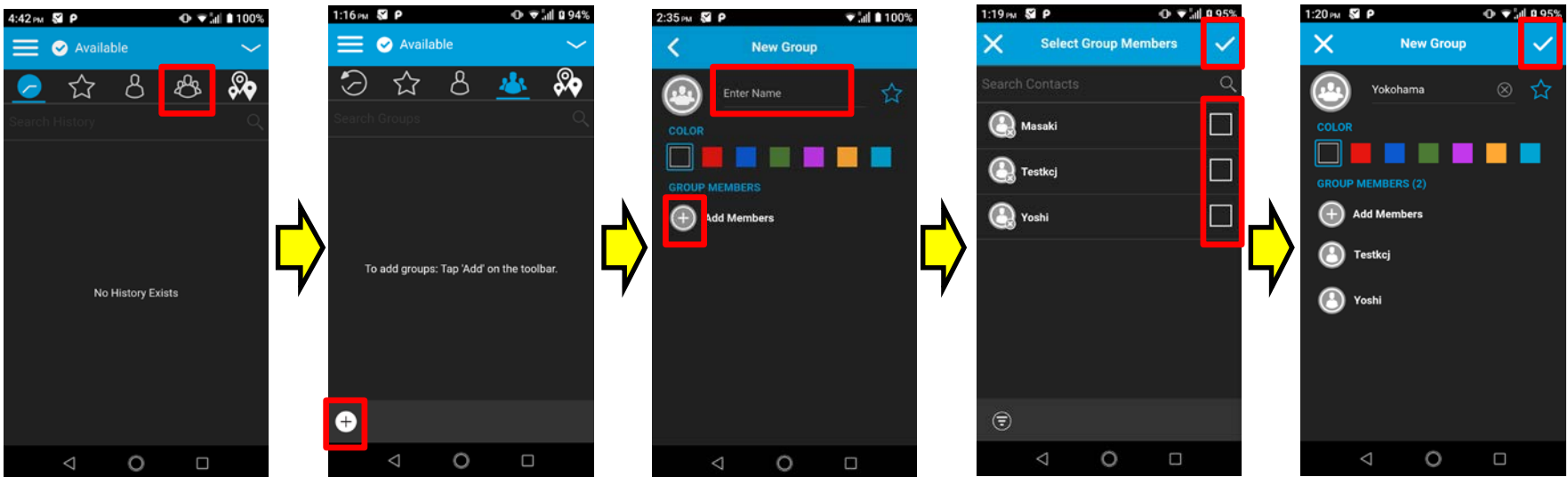

Add a Group Contact

1. Tap > AT&T EPTT
2. Tap > .
3. Enter the group's name, tap to add the members.
4. Select the check box next to the contact(s) you want to add.
5. Tap > .



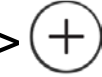

Add a Contact to Favorite

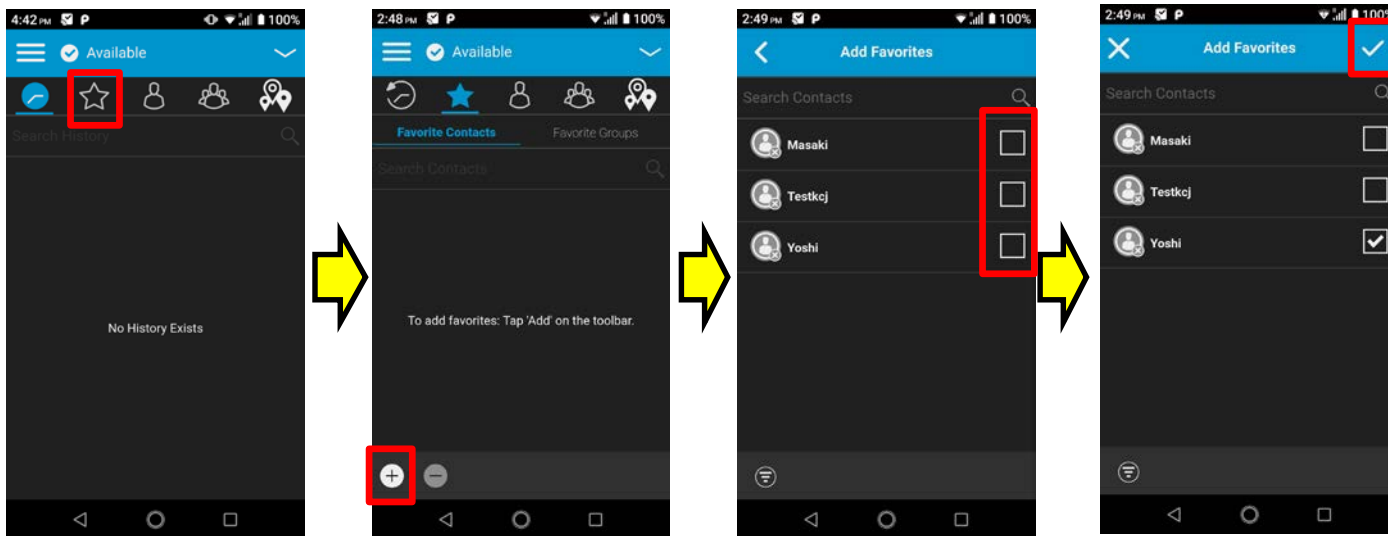
1. Tap  > **AT&T EPTT**.
2. Tap  >  .
3. Select the check box next to the contact(s) you want to add.
4. Tap  .



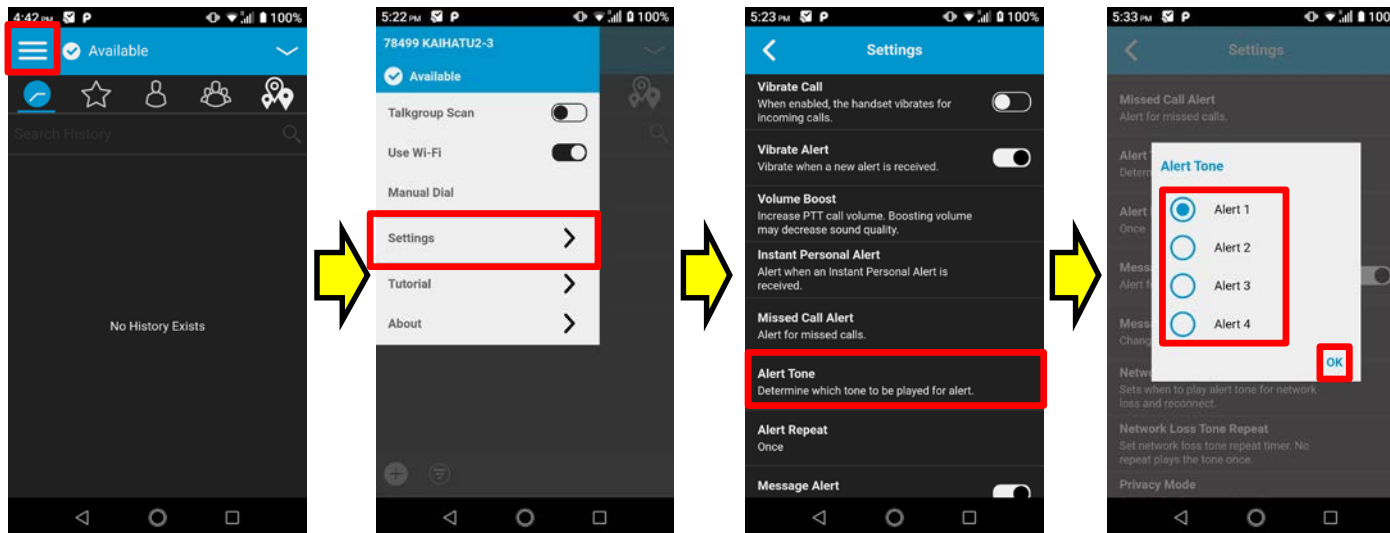

Alert Tone

1. Tap  > **AT&T EPTT**.
2. Tap  > **Settings** > **Alert Tone**.
3. Select the desired tone (Alert1, Alert2, Alert3 or Alert4) and tap **OK**.



Make a Call

1. Tap  > AT&T EPTT
2. Tap  and tap the desired contact to call.
3. Press and hold the **PTT key** or blue microphone icon and begin speaking to make a call. The Microphone icon will be highlighted with a blue background.
4. After speaking, release the **PTT key** or microphone icon.

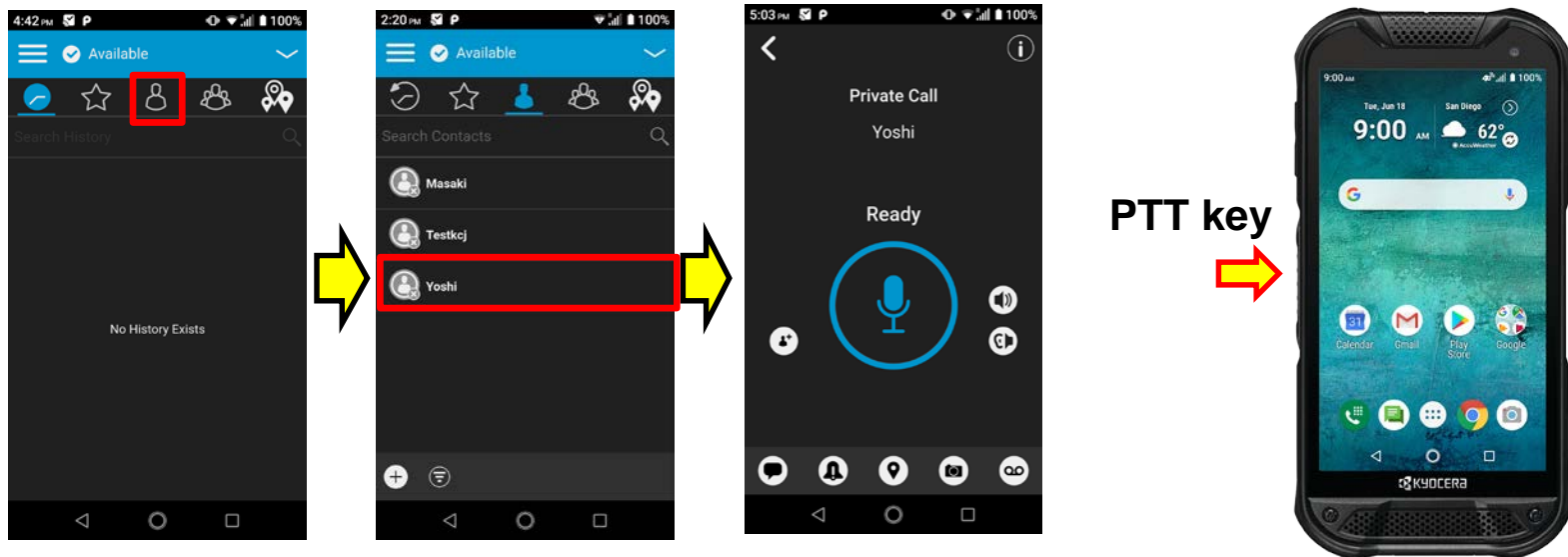

End a Call

1. Tap  > AT&T EPTT

